

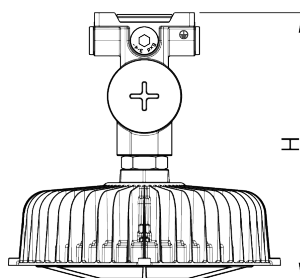

**Applications**  
Industrial Gas & Oil Plant  
Chemical & Steel Plant  
Electricity Facilities  
Gas Station

**Certification**  
KC

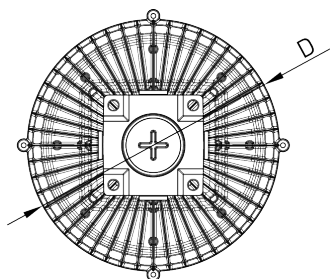

## Description

Integrated high power LED with excellent luminous efficacy, 130 lm/W  
The risk of fire and explosions, and has less impact on a strong structure  
Power coated aluminum fixture body  
Excellent cooling structure

## Specifications

<b>Model Name</b>		TAN080
<b>Power Consumption</b>		80W
<b>Light Source</b>		High Power LED Chips
<b>Correlated Color Temperature</b>		5000K (3000K / 5700K available)
<b>Luminous Flux *</b>		10,400 lm
<b>Luminous Efficacy *</b>		130 lm/W
<b>LED Driving Current</b>		-
<b>Color Rendering Index</b>		80 Ra
<b>Light Distribution</b>		110° / 140° (Option)
<b>LED Chip Manufacturer</b>		NICHIA
<b>Input Voltage</b>	100 ~ 240 Vac	100 ~ 277 Vac
<b>Input Current</b>	Max 1.0A (@100Vac)	
<b>Power Factor</b>	≥0.9 at Max load	
<b>Frequency</b>	50 / 60 Hz	
<b>Surge Protection</b>	Line-Line 2kV, Line-FG 4kV	
<b>Driver Type</b>	Constant Current (CC)	
<b>Fixture &amp; Driver Manufacturer</b>	KMW INC. / Made in Korea	
<b>Size ( D x H )</b>	Ø11.4 x 12.2 (inch)	Ø290.0 x 310.0 (mm)
<b>Weight (Driver included)</b>	20.9 lb	9.5 Kg
<b>Material</b>	<b>Body</b>	Cast Aluminum
	<b>Cover</b>	Tempered Glass 15.0T (Clear)
<b>Finish</b>		Powder Coating
<b>IP Rating</b>		IP66
<b>Mounting Option</b>		Surface Mount
<b>Operating Temperature</b>	-22°F ~ 104°F	-30°C ~ 40°C
<b>Life Time</b>	50,000 Hours (@77°F / 25°C)	
<b>Warranty</b>	5 Years (12 hours usage per day)	

## Option

<b>Light Distribution</b>	140° Reflective Shade
<b>Tilt Pipe</b>	45° Tilt Pipe

\*Tolerance : ± 5%

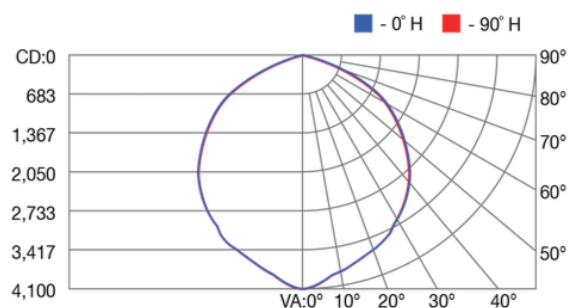

## Photometry

See photometric .ies files for details.



[ 5000K / 110° ]

Option

140° Reflective Shade	45° Tilt Pipe
	
140° Reflective Shade apply Sample Image	45° Tilt Pipe apply Sample Image
